







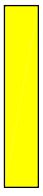

LEGEND

-  PROFILE GRADE LINE
-  C/L PROPOSED ROADWAY
-  PROPOSED BRIDGE STRUCTURE
-  PROPOSED ROADWAY, S.W. OR SHLDR./BIKE PATH
-  PROPOSED REQ'D. R/W
-  APPARENT EXIST. R/W
-  MATCHLINE
-  EXIST. R.R. SPUR
-  PROPOSED R.R. CROSSING
-  EXISTING SIGNALIZED INTERSECTION

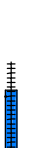

C/L CURVE DATA
 P.I. STA. 283+21.41
 $\Delta = 1026.33^\circ$
 $D = 02.99109^\circ$
 $T = 175.35'$
 $L = 349.72'$
 $R = 1,918.85'$

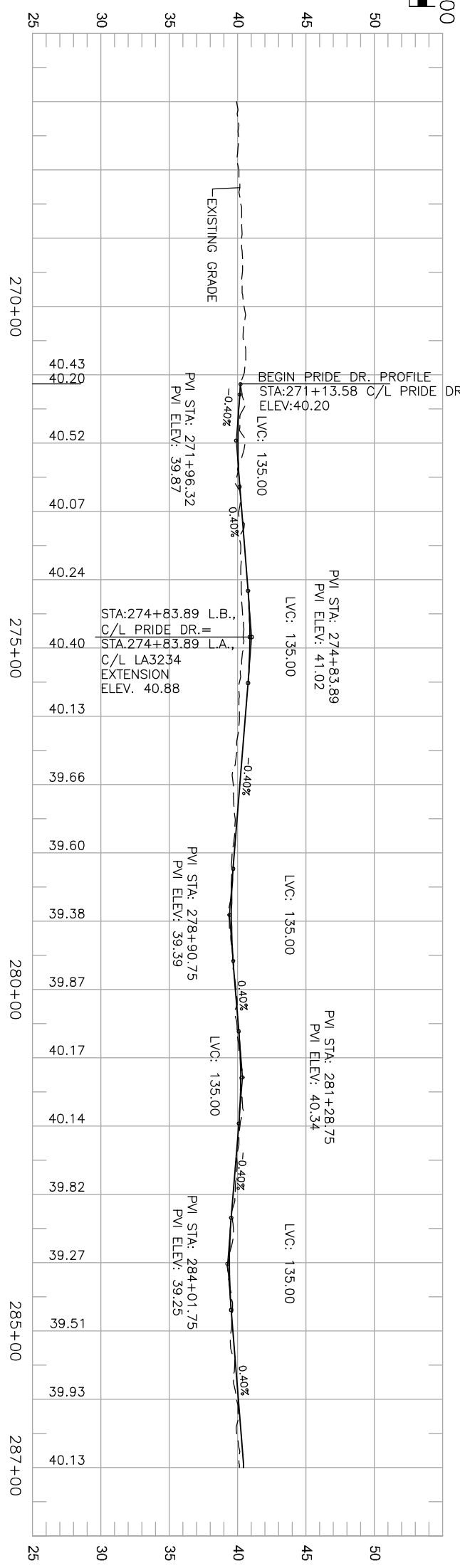
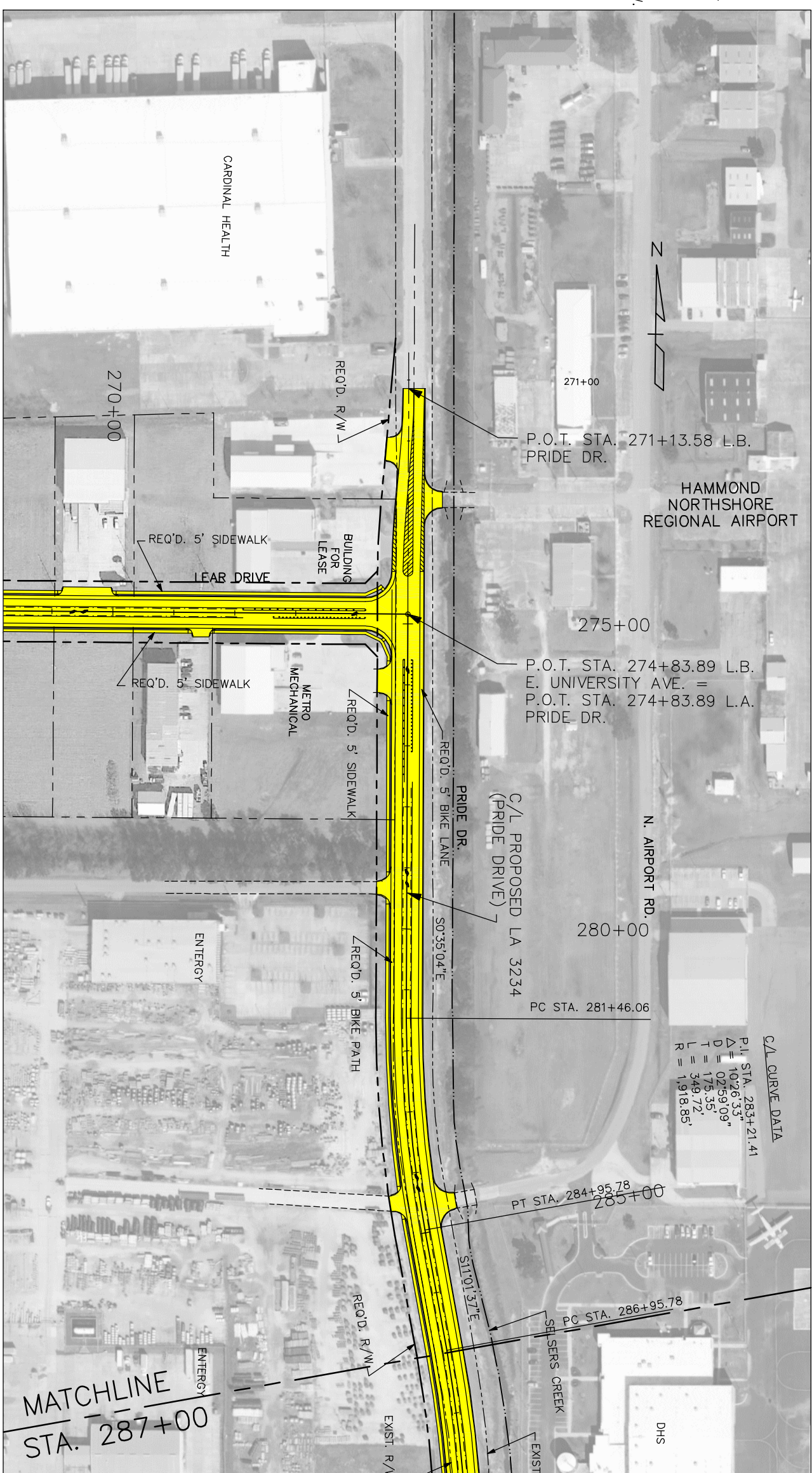

PLAN LAYOUT - ALTERNATE B
 LA3234 EXT. (LA1065-AIRPORT)



NO.	DATE	REVISION OR CHANGE ORDER DESCRIPTION	BY

DESIGNED	JES	PARISH	TANGIPAHOA
CHECKED	DGV	CONTROL SECTIONS	H008915
DETAILED	DGV	STATE PROJECT	H.008915.2
CHECKED	JES		
SHEET NUMBER	8 OF 9		